

9 Displacements 9 Schluckvolumen 9 Cylindrée 9 Despazamientos	(4.9 - 22.2 in <sup>3</sup> /rev) 81 . . . 364 cm <sup>3</sup> /rev	
Maximum Pressure Eingangsdruk Pression entrée Presion Maxima	Cont. (3000 psid) . . . 207 bar	Int. (4000 psid) . . . 276 bar
Maximum Oil Flow Schluckstrom Débit d'huile Caudal Maximo de Aceite		(25 gpm) . . .95 lpm
Maximum Speed Drehzahl Vitesse de rotation Velocidad Maxima		(749 rpm) 749 rpm
Maximum Torque MaxDrehmoment Couple Torque Maximo	Cont. (4502 lb in) 509 Nm	Int. (7029 lb in) 794 Nm

The Clutch Motor consists of a TF Series motor separated from the output shaft by a face spline coupling. The coupling is held apart by springs, disconnecting the motor from the output shaft, allowing the output shaft to freewheel. When hydraulic pressure is applied to either motor port, the springs separating the coupling are overcome and the motor is coupled to the output shaft.

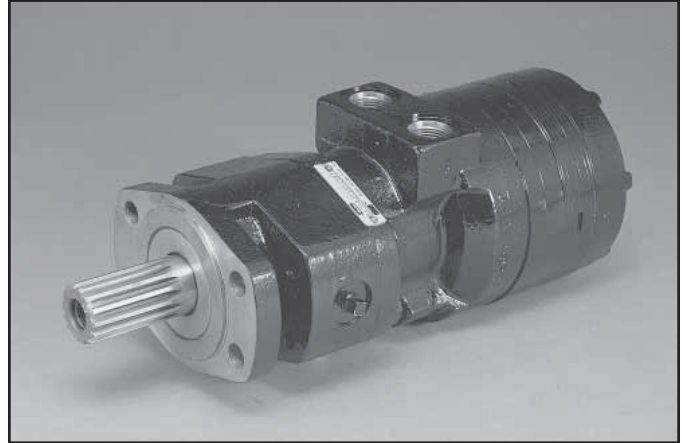

Notes:

- 1) It is not recommended to engage the clutch while the output shaft is rotating.
- 2) Clutch may not disengage if there is residual torque on output shaft when pressure is lost at motor ports.
- 3) Minimum pressure to engage clutch - 200 PSI.
- 4) To assure clutch disengagement, pressure at motor ports must be below 60 PSI.
- 5) Shaft will freewheel when pressure is lost at motor ports whether by design or inadvertently. The possibility of unplanned freewheeling should be considered in the design of the system.
- 6) If applicable, contact factory for radial load capacity.

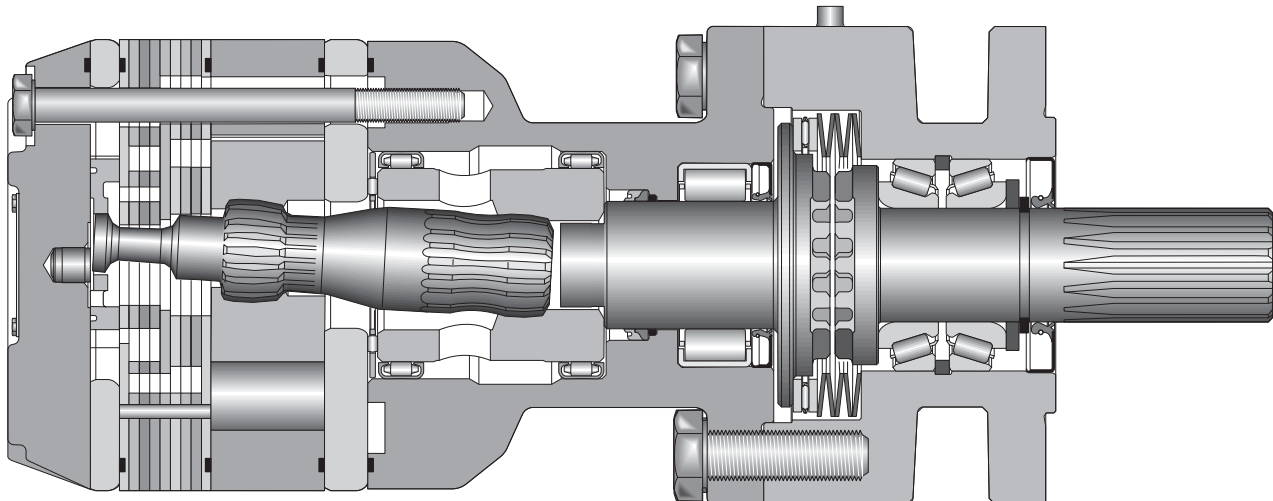

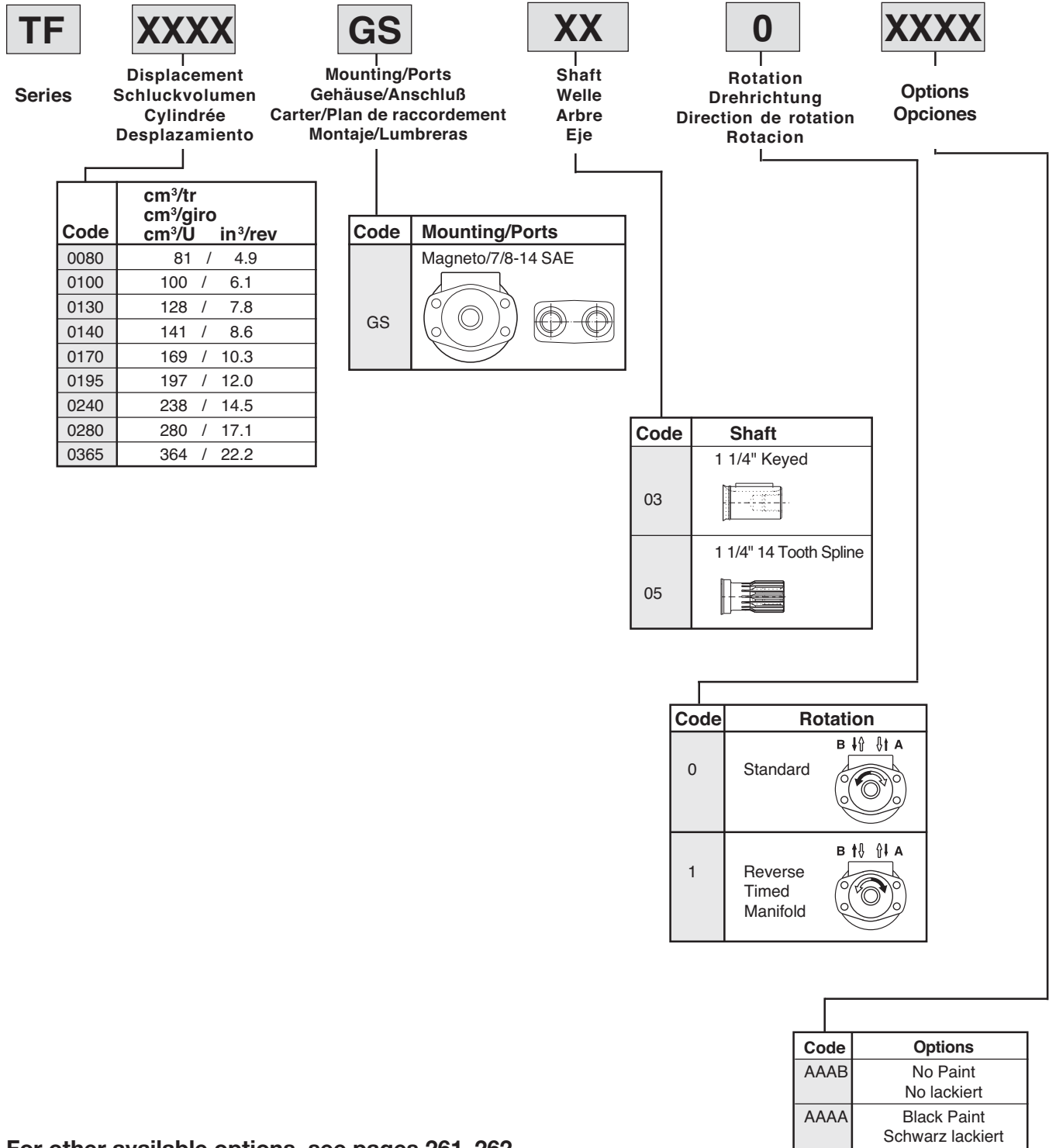

For other available options, see pages 261–262.

Code: GS

4 Bolt Magneto, Clutch / 7/8-14 SAE

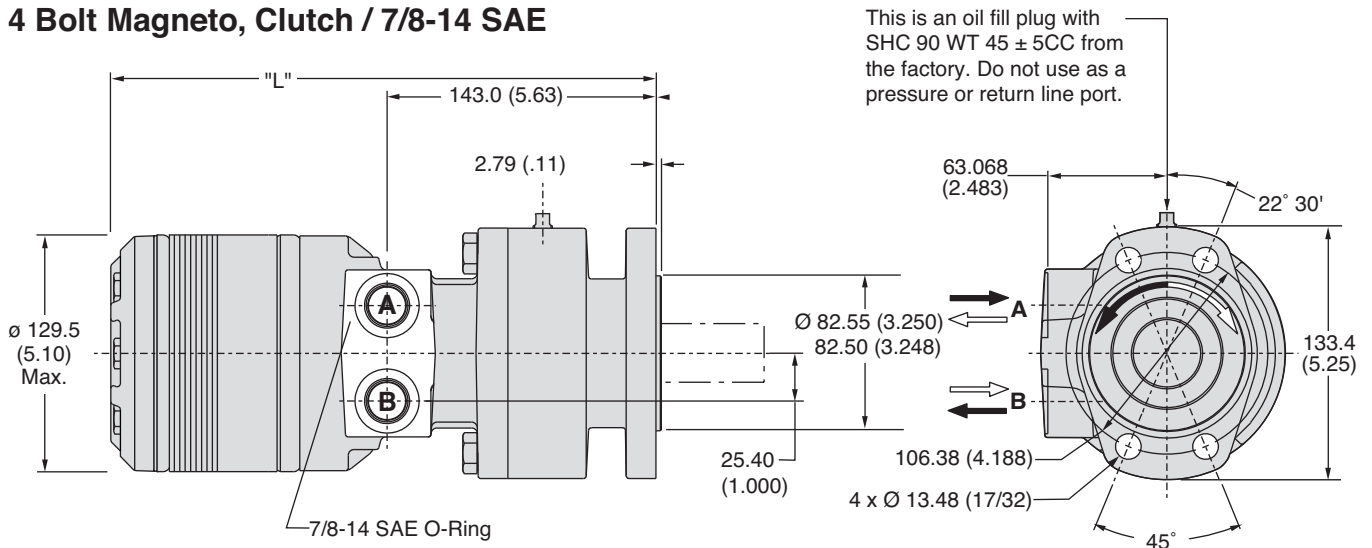

Code GS	disp.	0080	0100	0130	0140	0170	0195	0240	0280	0365
Weight/Gewicht	kg	17.9	17.9	18.1	18.2	18.5	18.8	19.2	19.5	20.3
Poids/Peso	(lb)	(39.3)	(39.4)	(39.9)	(40.1)	(40.7)	(41.3)	(42.3)	(42.9)	(44.6)
Length	"L" mm	270	270	273	275	278	281	286	290	300
	"L" (in)	(10.61)	(10.61)	(10.73)	(10.80)	(10.92)	(11.05)	(11.23)	(11.42)	(11.80)

For performance data curves, see TF section.

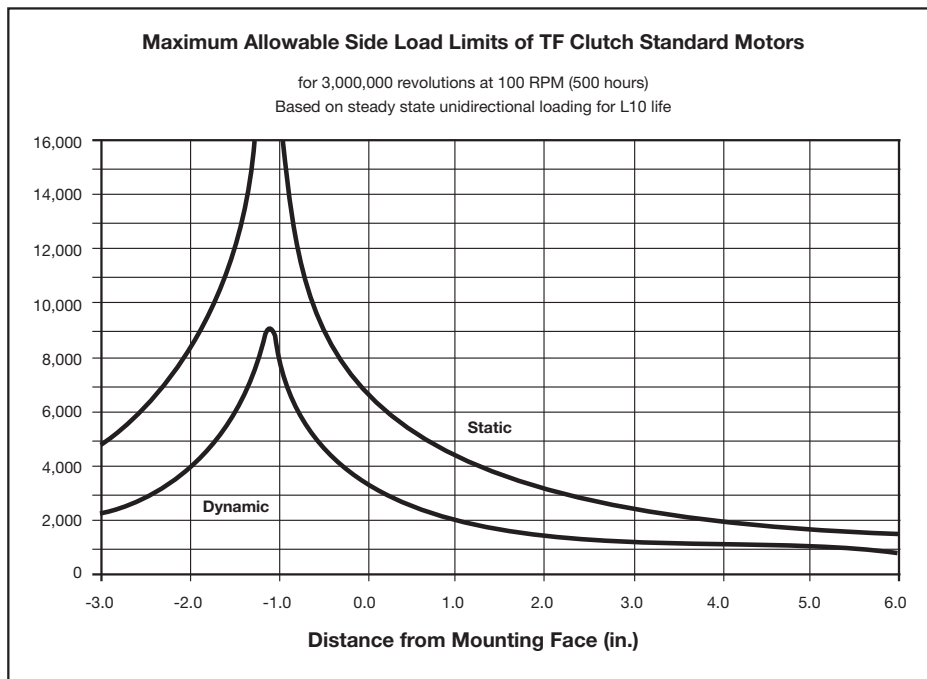

English equivalents for metric specifications are shown in ( ).

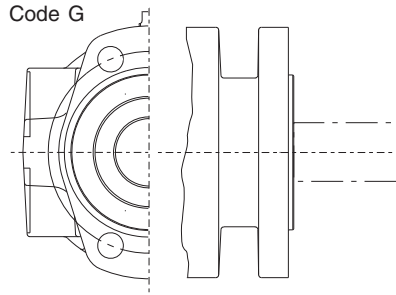

**Code: 03**

**1 1/4" Keyed**

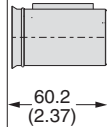

**Code: 05**

**1 1/4" 14 Tooth  
Spline**

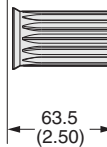

**Code: 03**

**1 1/4" Keyed**

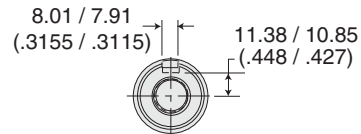
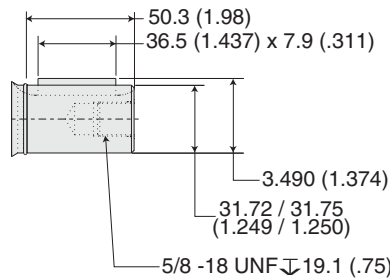

**Code: 05**

**1 1/4" 14 Tooth  
Spline**

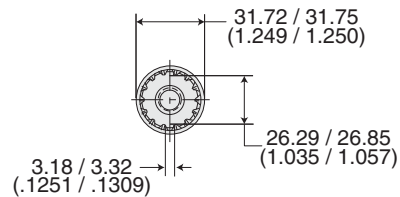
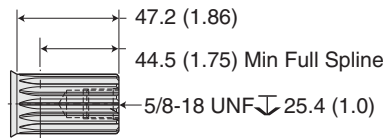

English equivalents for metric specifications are shown in ( ).

009 TF Clutch.indd, js